



Cooling Enclosure AS2100

User's Manual

Rev. 1.0

For use with AS2100

January 17, 2023

Acuity

A product line of Schmitt Industries, Inc.

2765 NW Nicolai St.

Portland, OR 97210

www.acuitylaser.com

Table of Contents

1. INTRODUCTION	3
2. PROTECTION RATING	3
3. INSTALLATION INSTRUCTIONS	4
3.1. 1. PREPARING THE ENCLOSURE	4
3.2. 1. MOUNTING THE ENCLOSURE	5
3.3. 1. INSTALLING YOUR COMPONENT(S) INTO THE ENCLOSURE.....	6
3.4. 1. SEALING THE ENCLOSURE	7
3.5. 1. AIR-COOLING	7
4. CLEANING AND MAINTENANCE.....	8

1. Introduction

Developed and tested by ACUITY LASER, this enclosure was designed to protect your device(s) in harsh, industrial environments. Follow this guide for instructions on assembling and maintaining the enclosure while ensuring the performance of the integrated component.

2. Protection Rating

Enclosure properties are equivalent to NEMA 6 / IP68, guaranteed to be dust tight as well as protecting against continuous liquid immersion. Enclosures are constructed and fastened with Corrosion-Resistant 316 Stainless Steel bolts.

All gaskets are made from a silicone rubber. The viewport window is a universal optical glass with a VIS-NIR coating on it.

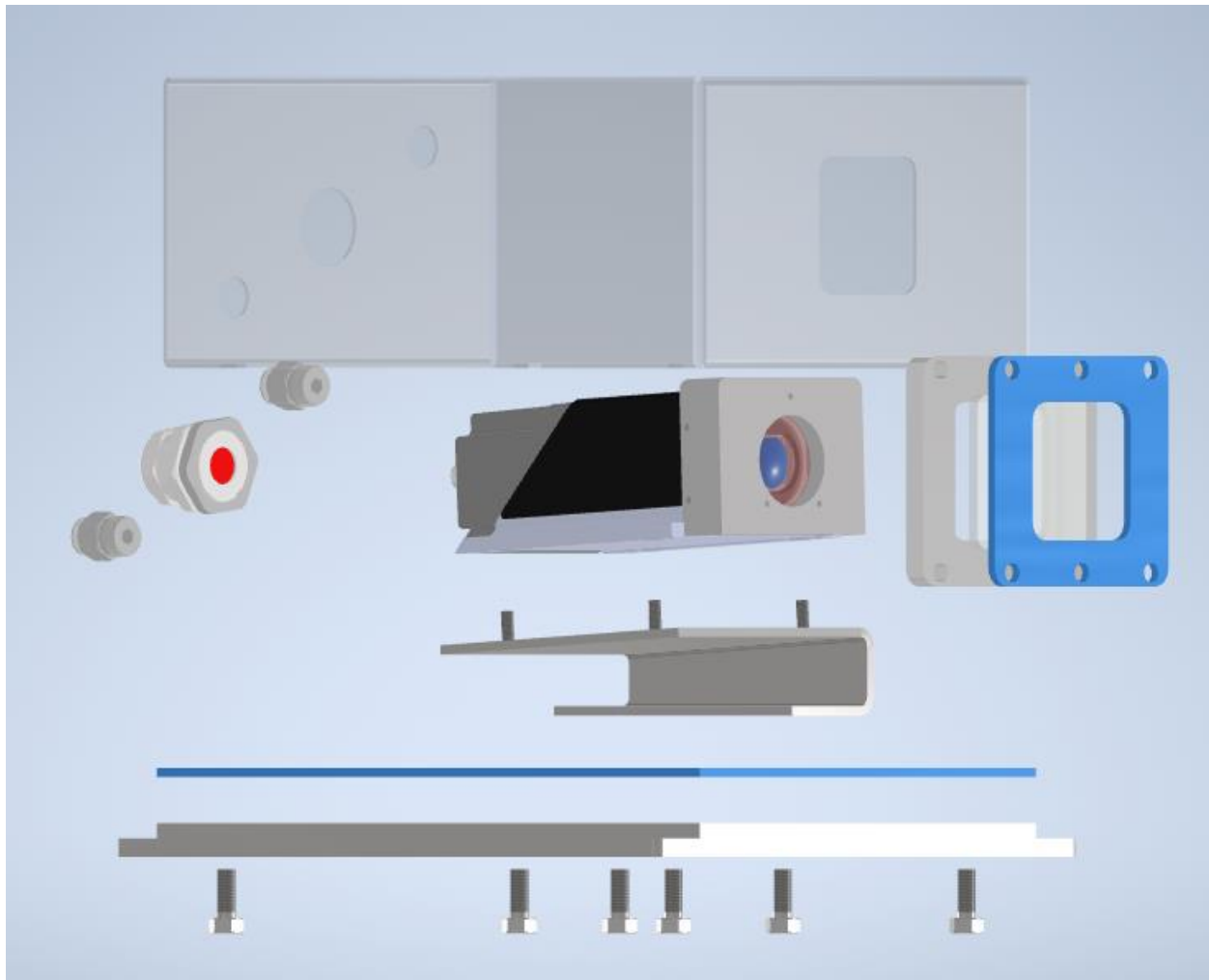

3. Installation Instructions

You may need the following tools:

- 10mm driver for M6 Hex-Head bolt
- 7mm driver for M4 nut

3.1. 1. Preparing the Enclosure

Loosen the M6 hex head bolts around the base of the enclosure.

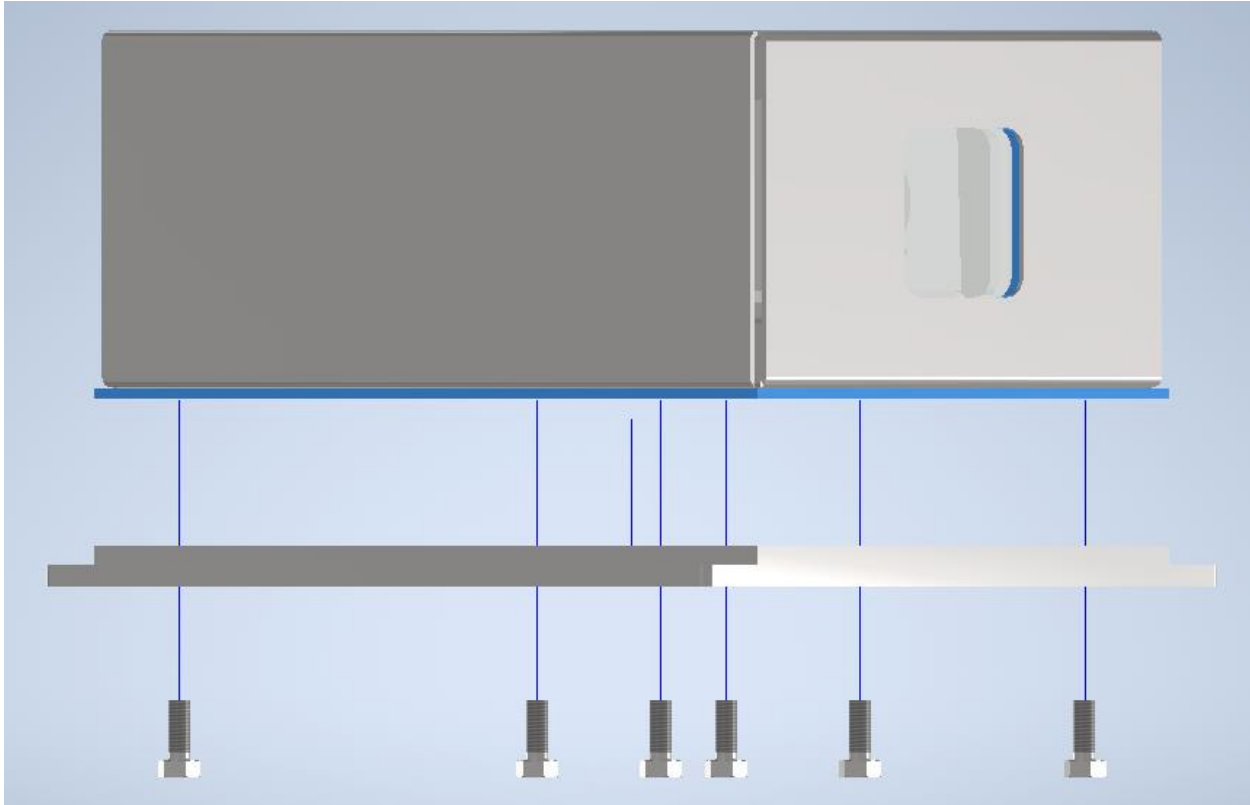

Do not remove any fasteners around the viewport unless to replace a damaged window. These will be 7mm hex nuts on the inside of the enclosure.

3.2. 1. Mounting the Enclosure

Four, M6 bolts run through the 4 corners of the base of an enclosure to secure an assembly.

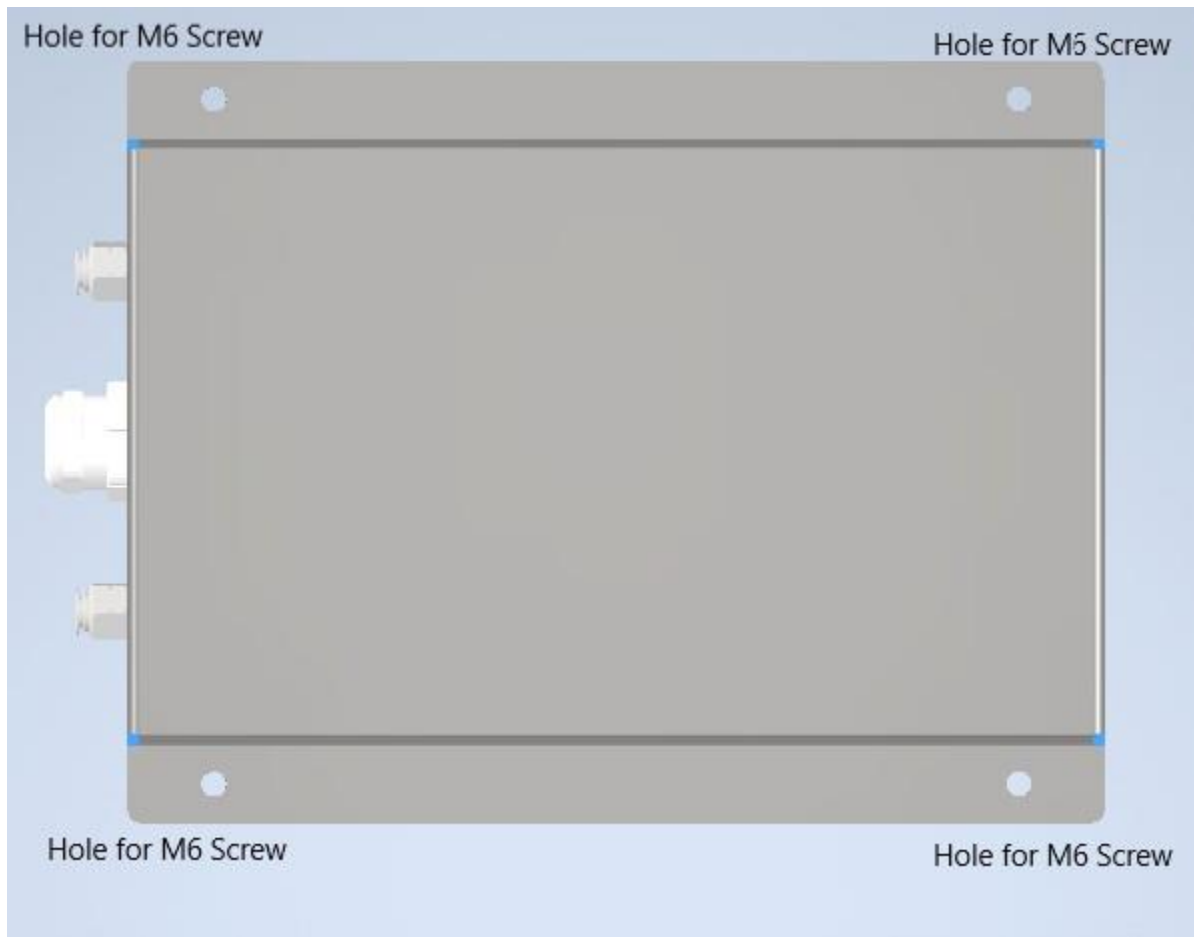

3.3. 1. Installing Your Component(s) into the Enclosure

Align the mounting holes on your sensor with the mounting base threaded studs in the enclosure.

Secure your device to the mounting base using the fasteners provided with your device (if not use four of the M4 nuts).

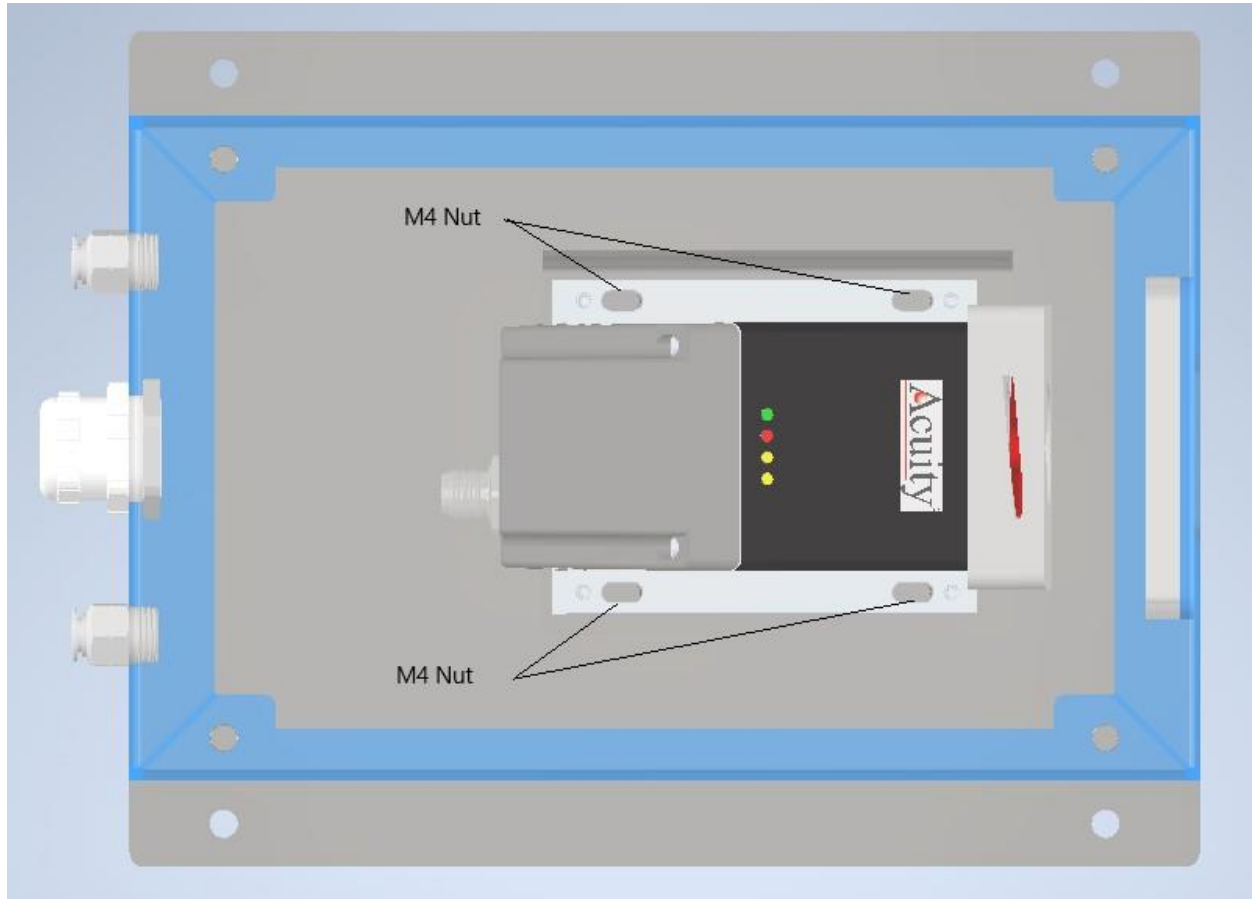

3.4. 1. Sealing the Enclosure

With your component(s) installed in the enclosure, reinstall the protective enclosure body using the bolts removed in Step 1.

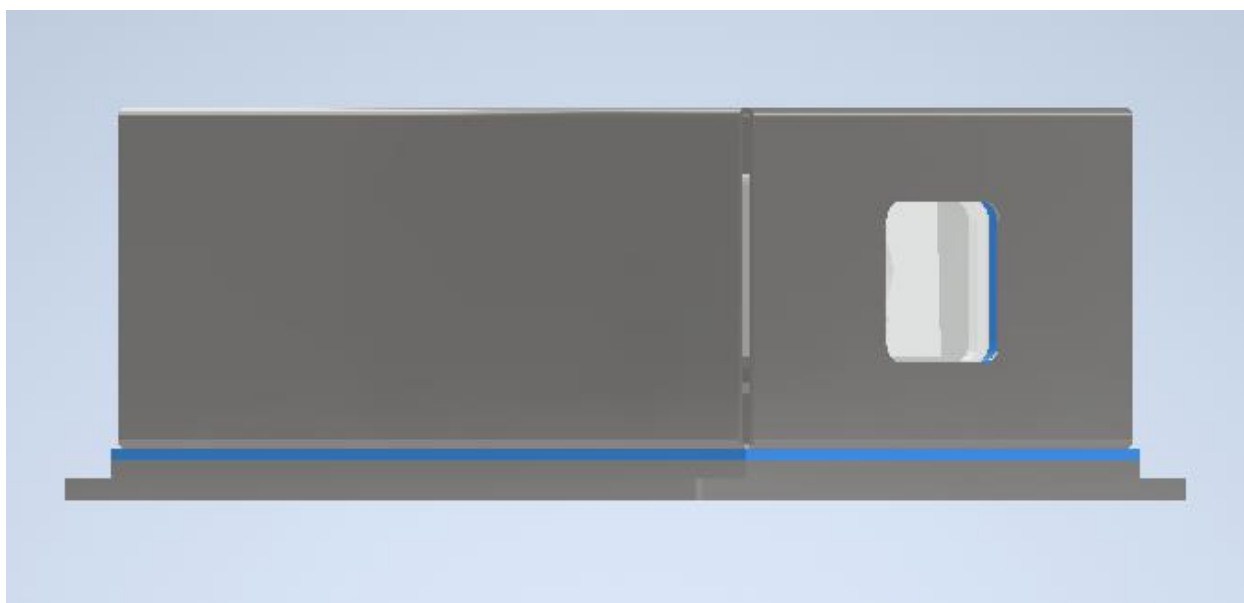
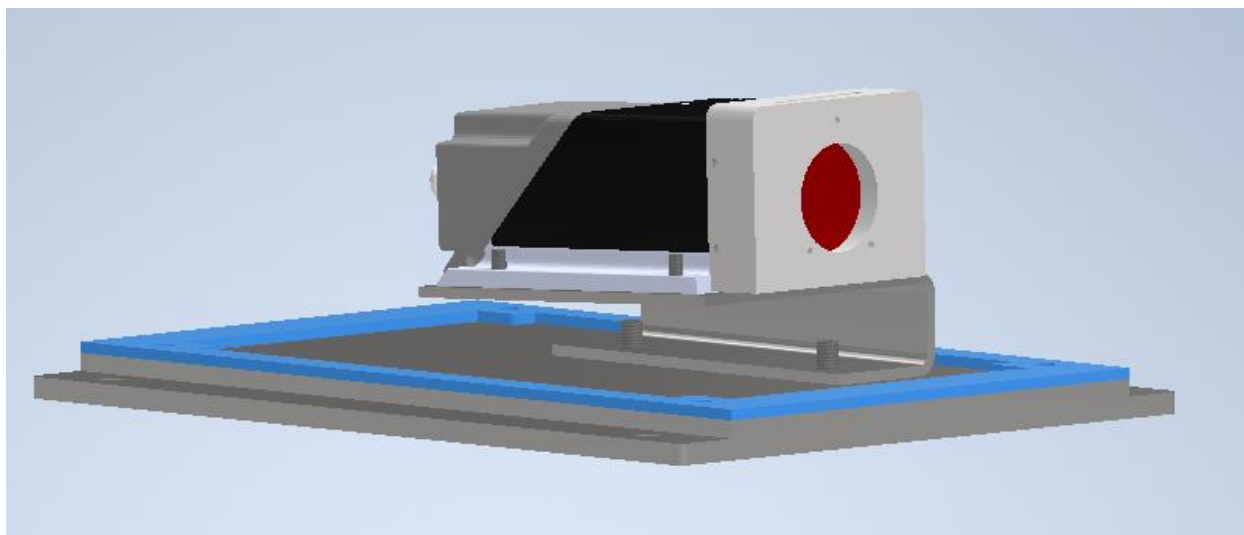

3.5. 1. Air-Cooling

Enclosure is equipped with a Push-to-Connect tube fitting, make sure your air supply is clean and dry. Long air lines can accumulate moisture in humid environments.

Recommended supply air pressure is 2-5 PSIA (0.138-0.345 Bar).

4. Cleaning and Maintenance

Stainless Steel:

When cleaning the stainless-steel body of your enclosure be sure to avoid bleach and cleaners with chlorine as these will stain and damage the surface. Additionally, steel wool and brushes should be avoided to preserve the polished finish.

Optical Glass Window:

It is important to routinely clean the surface of your enclosure's window to maintain visibility. For glass, make sure the surface is wet before cleaning to avoid scratching the surface. A microfiber towel is recommended for wiping down the surface when you are finished washing.